

Angular Contact Ball Bearings

Series 7200
 7200 B
 7300
 7300 B

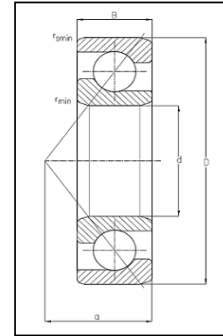

Bearing Type	Dimensions						Load Ratings		Speed Ratings (1/min)		
	d (mm)	D (mm)	B (mm)	rsmin (mm)	rmin (mm)	a (mm)	Ciso (kN)	Coiso (kN)	Thermal Reference Speed	Speed Limit	
										Grease	Oil
7201	12	32	10	0,3	0,6	14,22	7,02	3,41	21900	-	26000
7203	17	40	12	0,3	0,6	17,94	10,91	6,02	17700	-	20000
7204	20	47	14	0,6	1	21,05	13,31	7,63	16000	-	18000
7220	100	180	34	1,1	2,1	76	138,95	121,85	4500	-	4000
7310	50	110	27	1	2	47	68,20	47,88	6100	-	8000
7311	55	120	29	1	2	52	78,75	56,33	5700	-	7000
7320	100	215	47	1,1	3	90	201,62	188,71	3600	-	4000

Angular Contact Ball Bearings

Double Row

Series 3200
 3200 N

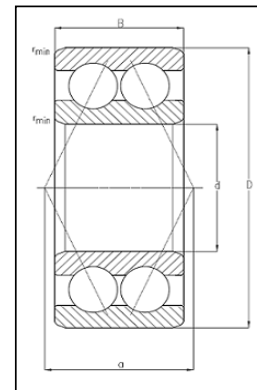

Bearing Type	Dimensions					Load Ratings		Speed Ratings (1/min)		
	d (mm)	D (mm)	B (mm)	rmin (mm)	a (mm)	Ciso (kN)	Coiso (kN)	Thermal Reference Speed	Speed Limit	
									Grease	Oil
3201	12	32	15,9	0,6	16,66	10,66	5,87	16500	15000	22000
3204	20	47	20,6	1	23,96	19,60	12,43	11500	10000	14000
3205	25	52	20,6	1	35	21,29	14,71	9700	8500	12000
3206	30	62	23,8	1	41	29,57	21,08	8500	7500	10000
3208	40	80	30,2	1,1	52	44,13	33,31	7100	5600	8000
3209	45	85	30,2	1,1	56	49,54	38,12	6400	5300	7500
3210	50	90	30,2	1,1	59	52,99	43,30	5800	4800	7000
3211	55	100	33,3	1,5	64	65,49	54,85	5400	4500	6300
3212	60	110	36,5	1,5	53,85	72,20	60,90	5100	4000	5600

3215	75	130	41,3	1,5	61,37	94,73	84,18	4400	3200	4500
------	----	-----	------	-----	-------	-------	-------	------	------	------